

Delock External Enclosure M.2 SSD 42/60/80 mm > SuperSpeed USB 10 Gbps (USB 3.1 Gen 2) USB Type-C™ female toolless

Description

This enclosure by Delock enables the installation of an M.2 SSD in 2280, 2260 and 2242 format, it can be connected via USB to the PC or laptop.

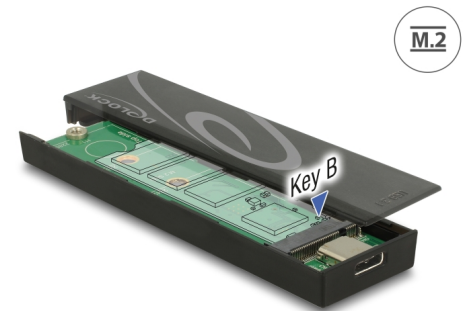

Item no. 42597

EAN: 4043619425976

Country of origin: Taiwan,
Republic of China

Package: Retail Box

Specification

- Connectors:
external: 1 x SuperSpeed USB 10 Gbps (USB 3.1 Gen 2) USB Type-C™ female
internal: 1 x 67 pin M.2 key B slot
- Chipset: Asmedia ASM1351
- Supports M.2 modules in format 2280, 2260 and 2242 with key B or key B+M based on SATA
- Maximum height of the components on the module: 1.35 mm, application of double-sided assembled modules supported
- Data transfer rate up to 6 Gbps
- LED indicator for power and access
- Maximum power for modules: 3 A
- Short circuit protection, over heating protection
- ESD protection up to 2 kV
- Hot Plug, Plug & Play
- Supports S.M.A.R.T.
- Supports TRIM

- Supports DevSleep
- Supports Native Command Queuing (NCQ)
- Dimensions (LxWxH): ca. 102 x 28 x 10 mm

System requirements

- Windows 7/7-64/8.1/8.1-64/10/10-64, ex Linux Kernel 4.4.x
- PC or laptop with a free USB Type-A port

Package content

- External enclosure M.2
- Mounting material
- Cable USB 3.1 Type-A to USB-C™, length ca. 15 cm
- User manual

Images

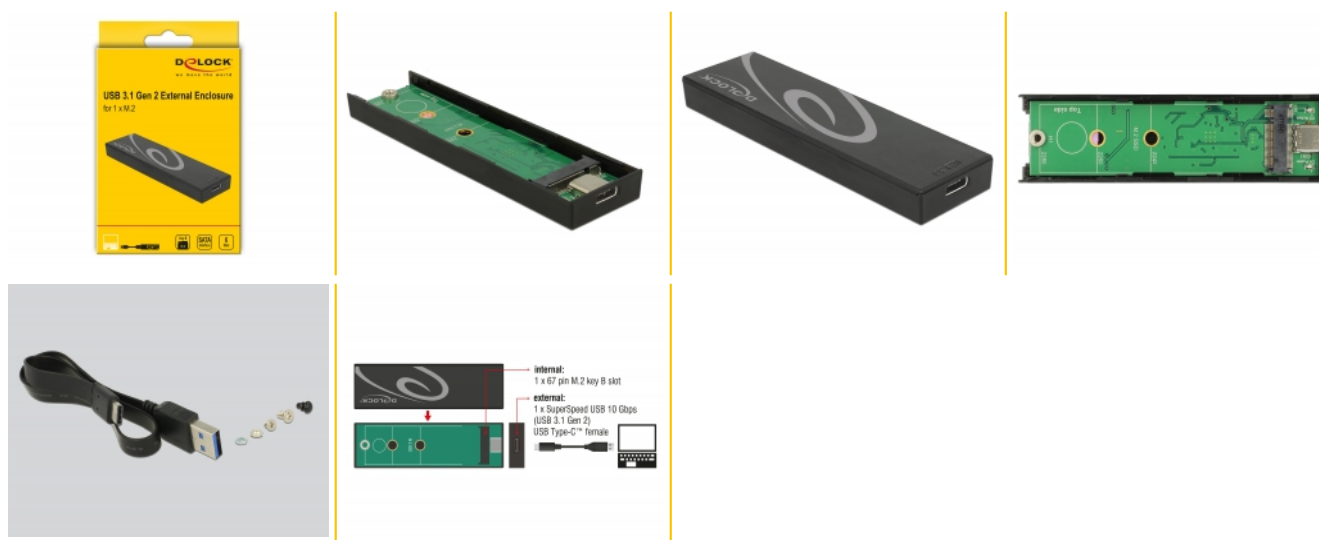

General

Function:	Hot Plug Plug & Play
Supported operating system:	Linux Kernel 4.4 or above Windows 10 32-Bit Windows 10 64-Bit Windows 7 32-Bit Windows 7 64-Bit Windows 8.1 32-Bit Windows 8.1 64-Bit
Supported module:	M.2 modules in format 2280, 2260 and 2242 with key B or key B+M based on SATA
Maximum height of the components on the module:	1.35 mm application of double-sided assembled modules supported

Interface

External:	1 x USB 10 Gbps USB Type-C™ female
Internal:	1 x 67 pin M.2 key B slot

Technical characteristics

Chipset:	Asmedia ASM1351
Data transfer rate:	6 Gb/s

Physical characteristics

Housing material:	Plastic
Length:	102 mm
Width:	28 mm
Height:	10 mm
Colour:	black