

Specifications

Qualified Screened Class 6, Connecting Hardware
Complied of ANSI/TIA-568-C.2
IEC 60603-7-51
ISO/IEC 11801 2.2 Edition
CENELEC EN 50173-1:2011

Electrical

Current Rating: 1.5 Amps Maximum.
Contact Resistance: 20 mOhm Maximum. at 100 mA max. 50 mV max.
Insulation Resistance: 500 MOhm Minimum. at 500V DC
Dielectric Withstanding Voltage: 1000 V AC RMS 60 Hz, 1 minute.

Mechanical

Durability: 1000 mating cycles.
Cable to Plug Tensile Strength: 20 lbs (89N) min.
Temperature: -40° C to 70° C

Physicals

Housing: Nylon.
Plug-Body: Polycarbonate (PC), UL 94V-0.
Wire-Holder: PBT+10%GF
Plug-Contact: T=0.35mm Phosphor Bronze,
Contact Area: Gold Over Nickel Plating.
IDC-Contact: T=0.4mm Phosphor Bronze, Sn over Nickel Plating.
Shielded-Base: T=0.5mm Brass, Nickel Plating.
Shielded-Cover: T=0.3mm Phosphor Bronze, Nickel Plating.
Accept Cable: #26~22AWG Solid Wire. Outer diameter 6.0~8.5

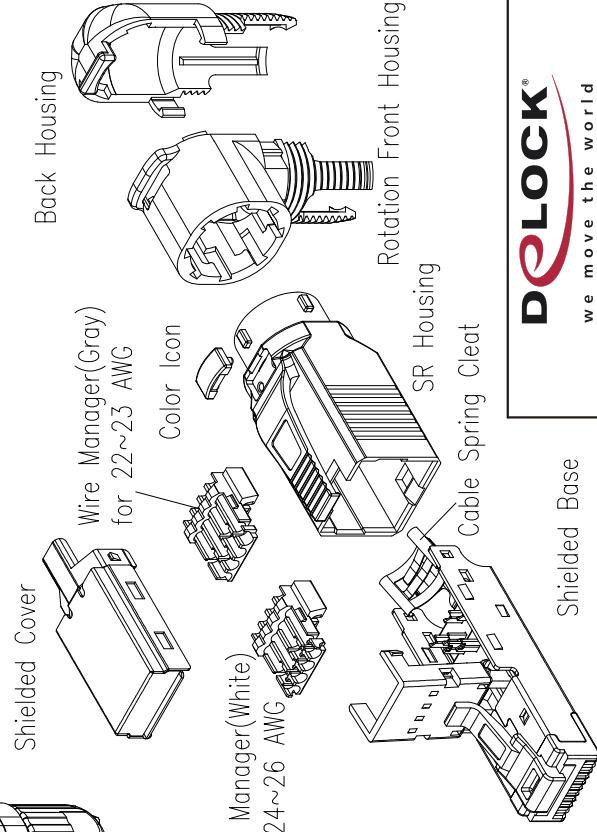
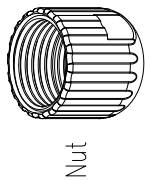
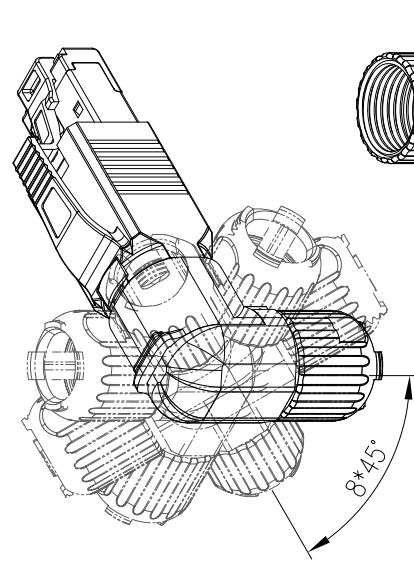
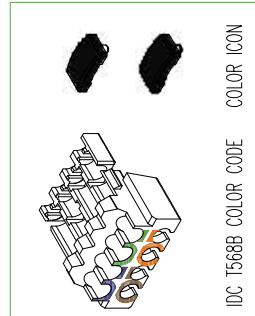
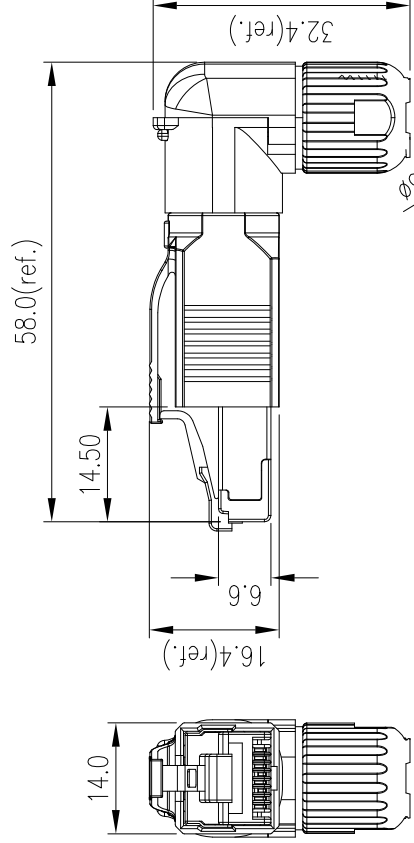
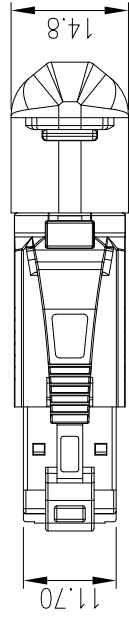

Date	2017 / 12 / 12	Title:	RJ45 Plug field assembly Cat.6A angled
Unit	mm	Item no.	86295
Projection		Barcode	4043619862955
Rev	A	File No.	