

SCALE 1.5/1

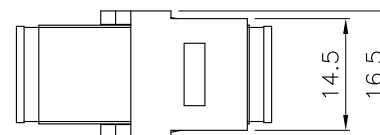
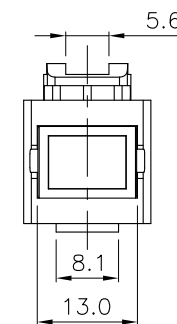
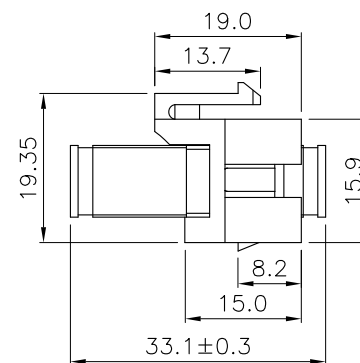
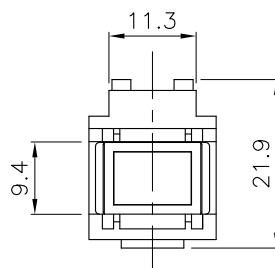

Specification :

Material :

- Dust Cover : PBT, Black color.
- Housing : PBT+glassfiber, UL 94V-0.
- Clip : STAINLESS.
- Insert : ABS, UL 94V-0.

Performance :

- SC Simplex Type.
- Durability : 500 cycles.
- Tensile Strength : 10 kgf.
- Insertion Loss : <0.2 dB(Singlemode)/<0.3 dB(Multimode).
- Operating Temperature: -20°C to +70°C.
- Storage Temperature: -40°C to +80°C.

DELOCK®
we move the world

Title: Keystone Module SC Simplex female

Date	2020 / 05 / 02	Item no.	86331
Unit	mm	Barcode	4043619863310
Projection		File No.	
Rev	A		